



ATHLETIC ARCHITECTURE

ARE YOUR FACILITIES

INSPIRATIONAL AND SACRED?



SPORTS ARCHITECTURE MUST BE INSPIRATIONAL. How can architecture affect athletic performance? Fundamentally, it must be Functional. There must be a clear and concise organization built around the routine and pragmatic. But most importantly, it must be

Inspirational. The architecture must awaken the athlete. The architecture must encourage and motivate. It must not only give the athlete the tools to be successful, it must inspire. The architecture must accomplish this, be it game day or practice day. The architecture must take advantage of every opportunity to touch the spirit of the athlete. *Architecture, like the athlete, must never settle for average.*

SPORTS ARCHITECTURE MUST BE SACRED What makes a facility sacred? For the athlete, it is the competitive procession. It's the practice. It's the pre-game rituals. It's stepping into the atmosphere. For the spectator, it is being in the atmosphere. It is, for a brief moment, when all collective hearts beat as one. The architecture must consider every influence and maximize the experience for not only the athlete, but for the spectator as well. For this is a symbiotic relationship. Both feed off one another. The architecture must take advantage of the fact that both are expecting to have a spiritual experience. They must take pride and ownership in the "House". It must be a hallowed ground. If the architecture can achieve this, it will inspire great stories and legends. It will be Sacred Ground.

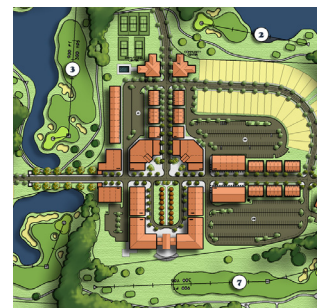
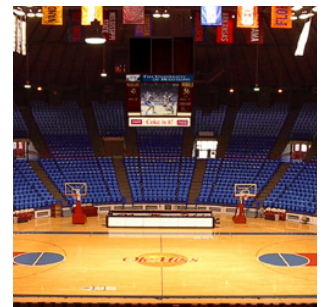

*It's not the will
to win that matters —
everyone has that.
It's the will to prepare
to win that matters."*
— Paul "Bear" Bryant

*He who stops being
better stops being
good.*
— Oliver Cromwell

O.P. Ferguson

FERGUSON & ASSOCIATES ARCHITECTS
100 Calumet Gardens, Suite 200 • Madison, Mississippi 39110
601.607.7933 • www.ferguson-architects.com



TAD SMITH COLISEUM RENOVATION

LOCATION: Oxford, MS **CLIENT:** The University of Mississippi **COST:** Renovation: \$5,000,000 Addition: \$20,000,000



PROJECT DESCRIPTION:

The first phase of this project consisted of retrofitting new seats and a general cosmetic face lift to the interiors. A new Jumbotron replaced the outdated scoreboard. Both the mechanical and electrical systems were renovated. Phase II consisted of a total renovation of the basement level of the coliseum: a new home locker facility, upgraded weight room and training room, visitor locker room, storage, laundry, equipment room, official dressing areas, and press conference area.

NEW TRACK FACILITY

LOCATION: Oxford, MS **CLIENT:** The University of Mississippi **COST:** \$3,500,000



PROJECT DESCRIPTION:

This project includes the relocation of the existing track to a location near the planned indoor track facility site. The facility includes a 290m track with locations for numerous field events including: shot put, hammer throw, discus, pole vault, long jump, triple jump, javelin, steeple chase and high jump. These field events are located inside and outside the oval. The facility incorporates grandstands, a judges' booth and a press box.

SOUTH END ZONE EXPANSION

LOCATION: Oxford, MS **CLIENT:** The University of Mississippi Athletics **COST:** \$28,000,000



PROJECT DESCRIPTION:

The Vaught/Hemingway Stadium South Endzone Expansion bowls in the south endzone portion of the stadium. This project connects both the west and east grandstands with a connection planned for the future indoor practice facility. This project includes approximately 30 private luxury skyboxes, 1,750 club level seats and 13,500 general seats. The new seating capacity of Vaught/Hemingway stadium is 60,000+/-; the largest on-campus stadium in Mississippi.

INDOOR PRACTICE FACILITY

LOCATION: Oxford, MS **CLIENT:** The University of Mississippi Athletics **COST:** \$18,000,000



PROJECT DESCRIPTION:

This project is located between the 400m outdoor track and the new South End Zone Expansion of Vaught-Hemingway Stadium. It contains a 200m track around a full-length football field. It will serve the function of housing practice areas for football, track, golf, tennis and baseball.